

NOVA Routing - CNC Machines

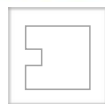

Grooving & Sizing

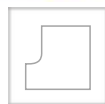

Profiling & Chamfering

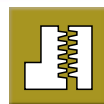

Jointing & Rebating



Carving



Clamping Systems & Adapters

Multi Profile Raised Panel Router Cutter

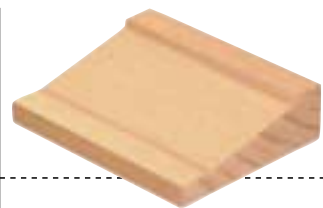
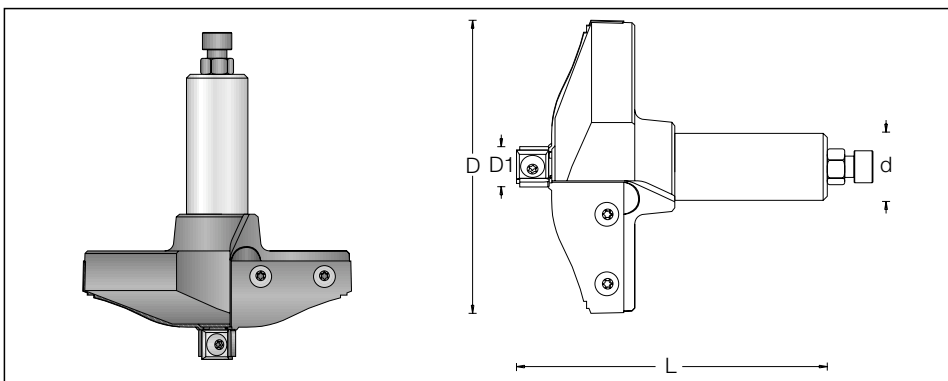

øD	Code No. Without trimmer	Profile No.	L	ød	n
112	822 031 H	1	110	25	12,000
	822 032 H	2	110	25	12,000
	822 033 H	3	110	25	12,000
	822 034 H	4	110	25	12,000
	822 035 H	5	110	25	12,000
	822 036 H	6	110	25	12,000
	822 037 H	7	110	25	12,000
	822 038 H	8	110	25	12,000

⚠ Available with or without trimmer bit "807 301 5"
Also available with 20mm diameter shank.

Spare parts:



T.C. Blade



Torx screw



Allen screw



Allen key



Torx key

Profile 1 #352 220 1 #193 148 1 #193 039 5 #194 020 0 194 101 5
M4x5.6 M4x5 S2 T - 15

Profile 2 #352 220 2
50x30.5x2

Profile 3 #352 220 3
50x30.5x2

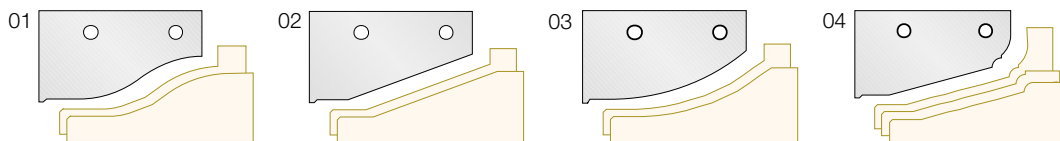

Profile 4 #352 220 4
50x30.5x2

Profile 5 #352 220 5
50x30.5x2

Profile 6 #352 220 6
50x30.5x2

Profile 7 #352 220 7
50x30.5x2

Profile 8 #352 220 8
50x30.5x2

Trimmer Bit

øD1	Code No	B	L	ød
18	807 301 5	12	31.8	8

Spare Parts:



T.C. Blade
310 121 2
12x12x1.5



Torx screw
193 148 2
M4x5.6



Torx key
194 101 5
T15

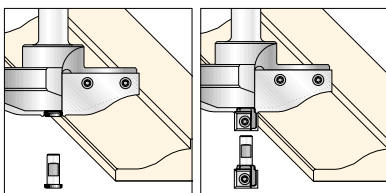

NOVA Routing - CNC Machines

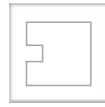

Grooving
& Sizing

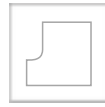

Profiling &
Chamfering

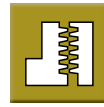

**Jointing &
Rebating**

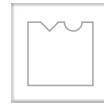

Carving



Clamping
Systems &
Adapters

Straight Rebater Router Cutter with Scorers

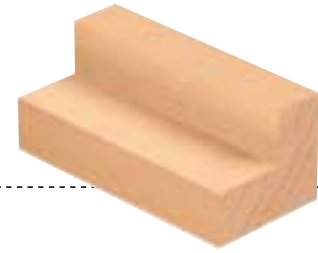
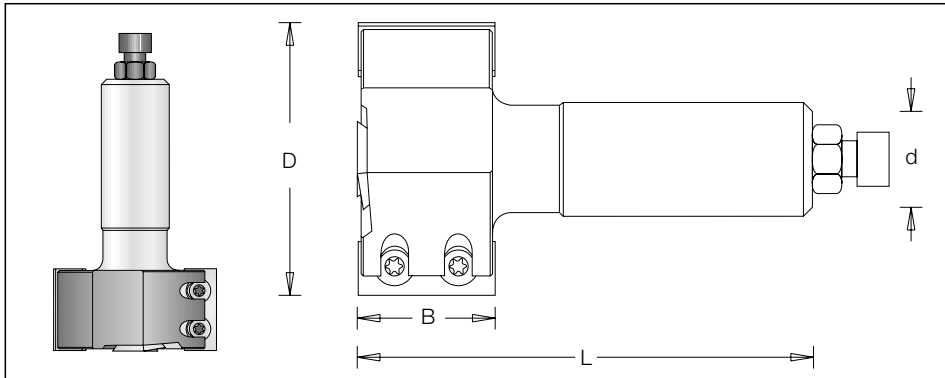

$\varnothing D$	Code No.	B	L	$\varnothing d$	n
40	807 330 H	30	100	25x55	18,000
	807 332 H	50	120	25x55	18,000
60	807 335 H	30	100	25x55	18,000
	807 337 H	50	120	25x55	18,000

Also available with 20mm diameter Shank.

Spare Parts:



T.C. Blade
310 123 0
30x12x1.5



T.C. Blade
310 125 0
50x12x1.5



T.C. Blade
300 850 3
14x14x2



Torx screw
193 148 2
M4x0.7



Torx key
194 101 5
T - 15



Torx key
194 106 0
T - 20

NOVA Routing - CNC Machines

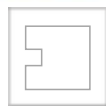

Grooving & Sizing

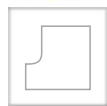

Profiling & Chamfering

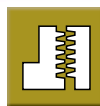

Jointing & Rebating



Carving



Clamping Systems & Adapters

Planning and Rebating Router Cutter

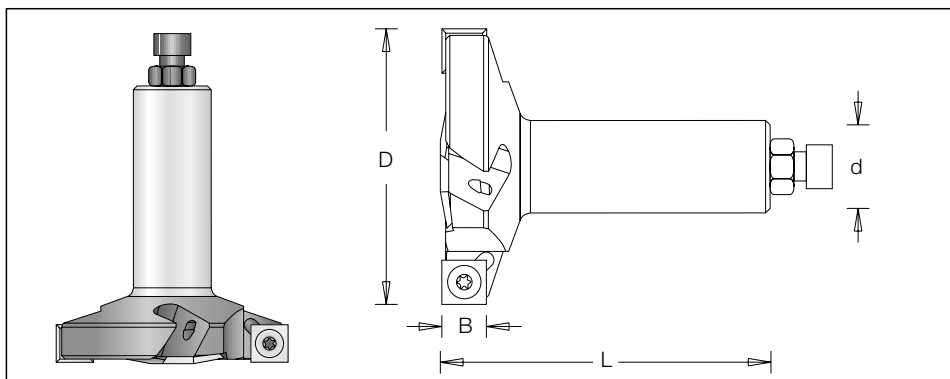

$\varnothing D$	Code No.	B	L	$\varnothing d$	n
80	807 340 H	12	90	25x55	18,000

⚠ Also available with 20 mm diameter shank.

Spare Parts:



T.C. Blade
310 121 2
12x12x1.5



T.C. Blade
300 850 3
14x14x1.5



Torx screw
193 395 0
M4x8



Torx screw
193 370 0
M5x6.3



Torx key
194 101 5
T - 15



Torx key
194 106 0
T - 20

Finger Joint Router Cutter

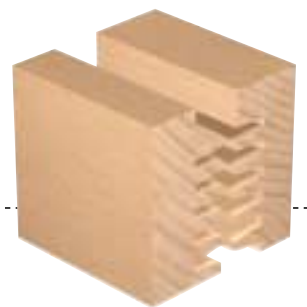
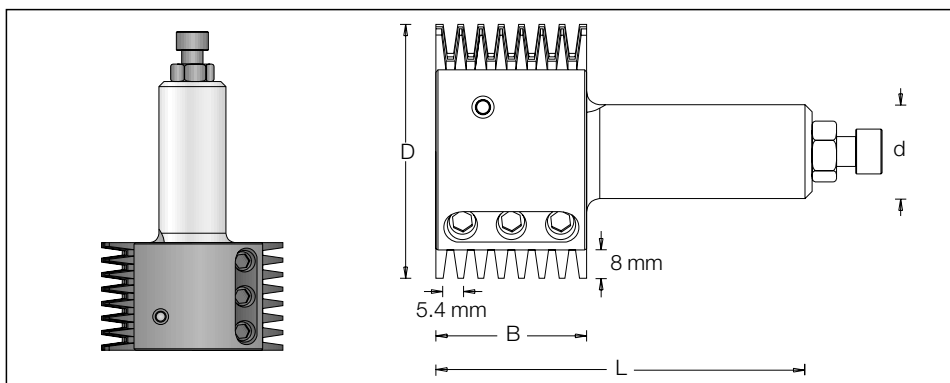

$\varnothing D$	Code No.	B	L	$\varnothing d$	n
70	856 011 0	40	100	25	12,000

⚠ Also available with 20 mm diameter shank.

Spare Parts:



T.C. Blade
315 650 2
40x28x1.5



Supporting plate
199 110 1
40x22.5x4



Allen screw
193 040 0
M8x10



Wedge
199 022 0
40x13.5x8



Allen key
194 003 6
S-4

NOVA Routing - CNC Machines

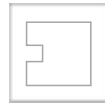

Grooving & Sizing

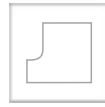

Profiling & Chamfering

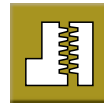

Jointing & Rebating

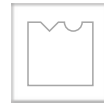

Carving



Clamping Systems & Adapters

Counter - Profile Cutters Set

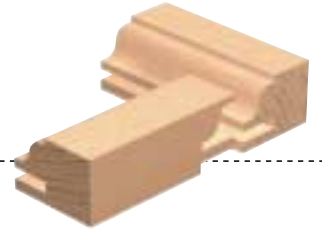
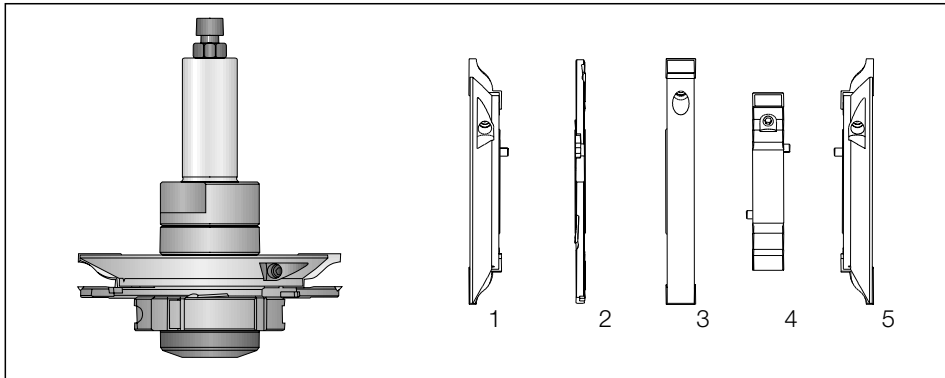

Set.No.	øD	Code No.	Cutters	B	Wood Sample Type	L	n
Set 1	120	842 021 H	1,2,3,4	20-35	1, 2	135	12,000
Set 2	120	842 022 H	1,2,3,4,5	20-35	1, 2, 3	125	12,000

⚠ Also available with HSK or ISO adapters.

Spare Parts:



Arbor

#190 820 H
L=135



Spacer

#196 360 0
5x45



Spacer

#196 365 0
10x45



Spacer

#196 370 0
13x45



Cover

#199 720 3
12x45



Arbor screw

#193 360 0
M5x20



Stopper screw

#193 042 0
M6x16



Allen key

#194 015 0
S4

øD	B	Code No.	Cutter No.	Profile	z	ød
120	16	842 011 3	1	1,2,3,4	2	20
120	16	842 111 3		1	2	20
120	16	842 211 3		2	2	20
120	16	842 311 3		3	2	20
120	16	842 411 3		4	2	20
120	5	842 012 3	2		4	20
120	15	842 013 3	3		2	20
88	15	842 014 3	4		2	20
120	16	842 015 3	5	1,2,3,4	2	20
120	16	842 115 3		1	2	20
120	16	842 215 3		2	2	20
120	16	842 315 3		3	2	20
120	16	842 415 3		4	2	20

Profiles for Cutters 1 & 5

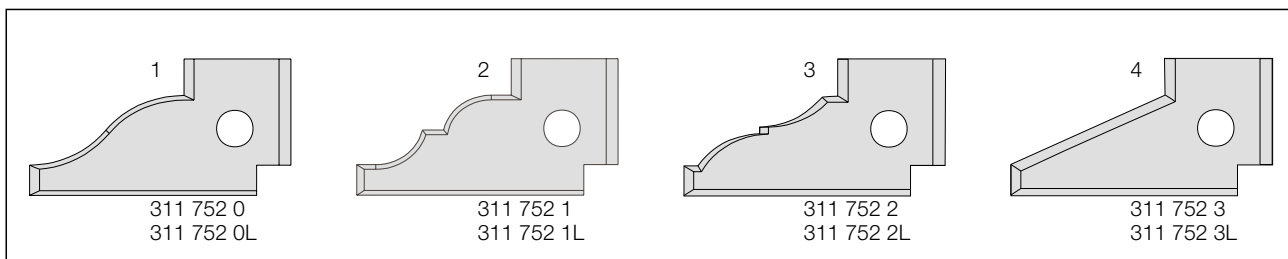

NOVA Routing - CNC Machines

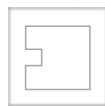

Grooving & Sizing



Profiling & Chamfering

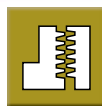

Jointing & Rebating



Carving



Clamping Systems & Adapters

Counter - Profile Cutters Set

Spare parts:

Cutter 1								
	T.C. Blade Profile 1 #311 752 0 15.7x30x2	T.C. Blade Profile 2 #311 752 1 15.7x30x2	T.C. Blade Profile 3 #311 752 2 15.7x30x2	T.C. Blade Profile 4 #311 752 3 15.7x30x2	Wedge #199 032 6 L=14	Allen screw #193 026 5 M6x16	Stopper screw #193 148 2 M4x6	Allen key #1940035 S3
Cutter 2								
	T.C. Blade #300 850 4 18x18x2.5	T.C. Blade #300 850 2 14x14x1.2	T.C. Blade nut #192 360 0 M4*0.5D=9.9	T.C. Blade nut #192 350 0 M4*0.5D=11.9	Allen screw #193 030 0 M4x4	Allen key #194 110 0 T9		
Cutter 3								
	T.C. Blade #311 451 2 14.3x12x1.5	Wedge #199 038 5 L=13.5	Allen screw #193 026 5 M6x16	Allen key #194 003 5 S3				
Cutter 4								
	T.C. Blade #300 052 7 15x12x1.5	Wedge #199 038 5 L=13.5	Allen screw #193 026 5 M6x16	Allen key #194 003 5 S3				
Cutter 5								
	T.C. Blade #311 752 0 L 15.7x30x2	T.C. Blade #311 752 1 L 15.7x30x2	T.C. Blade #311 752 2 L 15.7x30x2	T.C. Blade #311 752 3 L 15.7x30x2	Wedge #199 032 6 L=14	Allen screw #193 026 5 M6x16	Stopper screw #193 148 2 M4x6	Allen key #1940035 S3

